

### IMPORTANT INFORMATION

**Note!** Please visit [www.jeld-wen.com](http://www.jeld-wen.com) for additional resources and complete instructions. We have How-To videos and written Product Guides available for most products. Contact us for more information.

#### INCLUDED PARTS

- (2) Tilt sash pivot pins

#### PRECAUTIONS AND SAFETY

- Use proper and safe equipment and protective gear as necessary.
- Sash removal can be awkward and could cause physical injury or product damage; we recommend the help of a second person.
- Use caution when tightening screws to avoid stripping the screw holes.

#### NEEDED TOOLS

- Phillips head screwdriver
- Putty knife

### TILT SASH PIVOT PIN REPLACEMENT

1. Remove the sash and lay carefully upside down to gain access to the pivot pins. **See the Product Guide on [www.jeld-wen.com](http://www.jeld-wen.com) for complete instructions on sash removal.**
2. Using a Phillips head screwdriver, remove the screw holding the pivot pin.

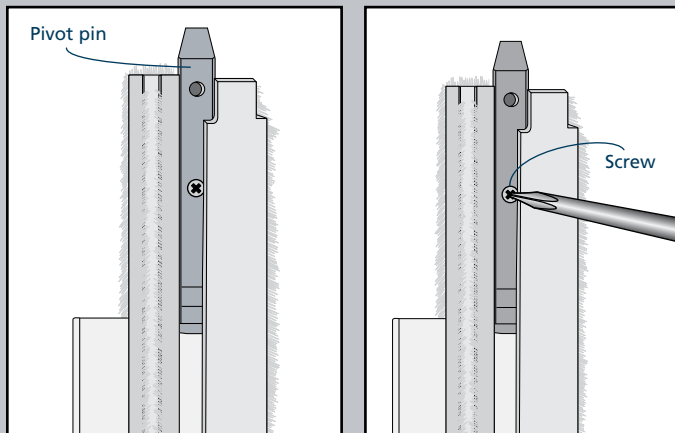

3. Slide the pivot pin out of the channel in the sash.
4. Orient the new pivot pin so that the tapered end is toward the outside and the flat portion is against the sash as shown. Slide the pivot pin into the channel in the sash until the hole lines up with the hole in the sash.

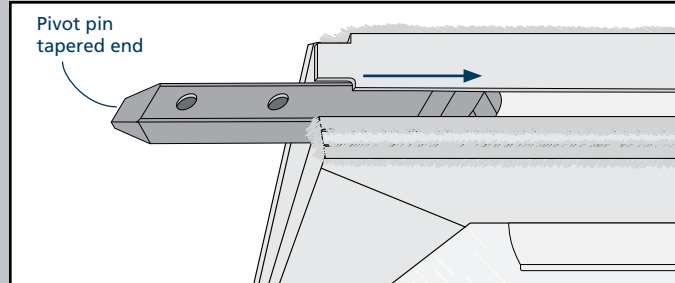

5. Install the screw (do not over tighten and strip the vinyl) in the new pivot pin and reinstall the sash.

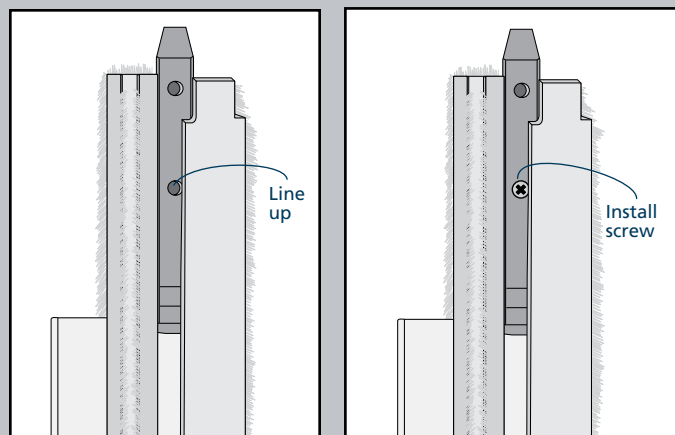

The advice offered herein can be done by a homeowner with some mechanical aptitude. If you are unsure, it is recommended that you hire a trained service provider such as a competent and licensed construction contractor or building professional. JELD-WEN disclaims any and all liability associated with the use and/or provision of these instructions. Any reliance upon the information or advice is at the risk of the party so relying. The information contained herein may be changed from time to time without notification.