

IMPORTANT INFORMATION

Note! Please visit www.jeld-wen.com for additional resources and complete instructions. We have How-To videos and written Product Guides available for most products. Contact us for more information.

Note! Operating sashes must be unlocked and open, or removed, before attempting lock removal. There is a metal stiffener in each sash. To avoid disturbing the location of the stiffener, if the sash(es) are removed, the lock rail must be kept horizontal before and during lock removal and installation.

INCLUDED PARTS

- Lock
- (2) Lock screws
- Keeper
- (2) Keeper screws

CAM-LOCK REPLACEMENT

CAM LOCK REPLACEMENT

1. Open or remove sash to prevent any interference with the keeper.

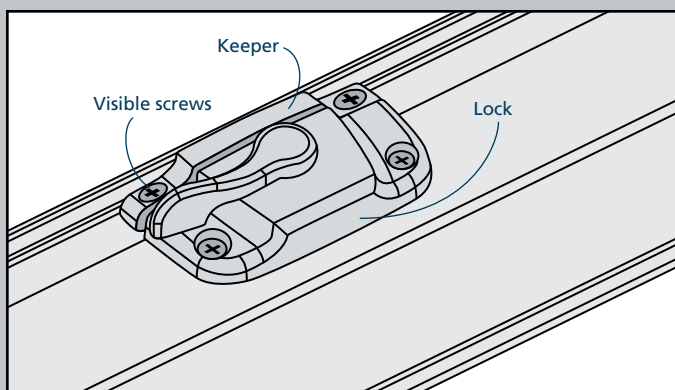

2. Unscrew one side and swing lock body free of unit.
3. Replace the removed screw into the existing hole to secure metal stiffener in place.

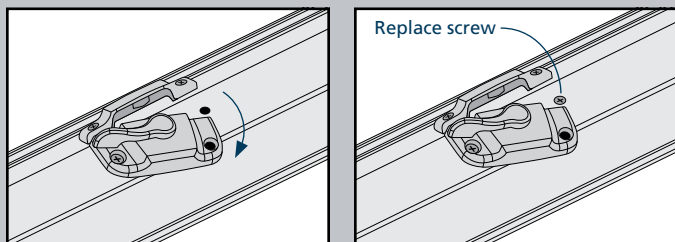

4. Unscrew the other side and remove the lock.
5. Reverse the steps to install the new lock, securing one side at a time.

PRECAUTIONS AND SAFETY

- Use proper and safe equipment and protective gear as necessary.
- Use extra care when driving screws near glass unit to avoid breakage.
- Use caution when tightening screws to avoid stripping the screw holes.
- Sash removal can be awkward and could cause physical injury or product damage; we recommend the help of a second person.

NEEDED TOOLS

- Phillips head screwdriver

CAM-LOCK KEEPER REPLACEMENT AND ADJUSTMENT

REPLACEMENT

1. Remove sash for unobstructed access to keeper.
2. Unscrew one side and swing keeper body free of unit.
3. Replace the removed screw into the existing hole to secure metal stiffener in place.

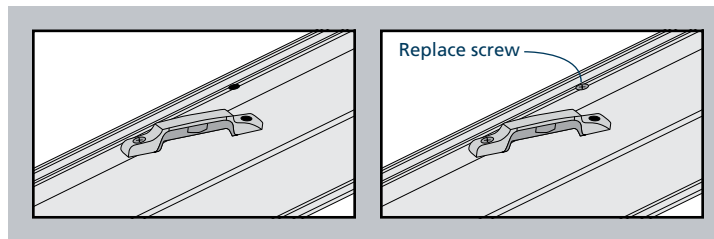

4. Unscrew the other side and remove the keeper.
5. Reverse the steps to install the new keeper securing one side at a time.
6. Close and lock the window to test for alignment.

ADJUSTMENT

1. Remove sash for unobstructed access to keeper.
2. Loosen both screws in keeper (do not remove).
3. Move keeper from side to side as necessary.
4. Re-tighten screws, close and lock window and test new alignment.

The advice offered herein can be done by a homeowner with some mechanical aptitude. If you are unsure, it is recommended that you hire a trained service provider such as a competent and licensed construction contractor or building professional. JELD-WEN disclaims any and all liability associated with the use and/or provision of these instructions. Any reliance upon the information or advice is at the risk of the party so relying. The information contained herein may be changed from time to time without notification.