



## IMPORTANT INFORMATION

**Note!** Please visit [www.jeld-wen.com](http://www.jeld-wen.com) for additional resources and complete instructions. We have How-To videos and written Product Guides available for most products. Contact us for more information.

### INCLUDED PARTS

- Lock lever
- Bezel

### PRECAUTIONS AND SAFETY

- Use proper and safe equipment and protective gear as necessary.

### NEEDED TOOLS

- Flat head screwdriver

## CASEMENT LOCK LEVER AND BEZEL REPLACEMENT

### Bezel Removal

1. Grip the bezel and pull straight out toward the interior until it snaps off.

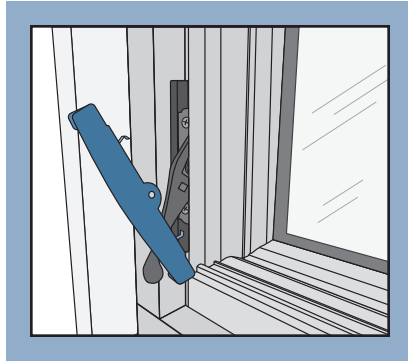

### Bezel Installation

1. Press the new bezel onto the lock mechanism until both springs engage and hold it into place.

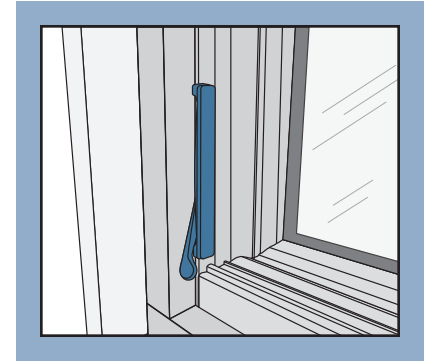

### Lock Lever Removal and Replacement

1. Insert a small screwdriver or similar tool into the slot to release the spring.
2. Pull the lever away from the window frame to remove.

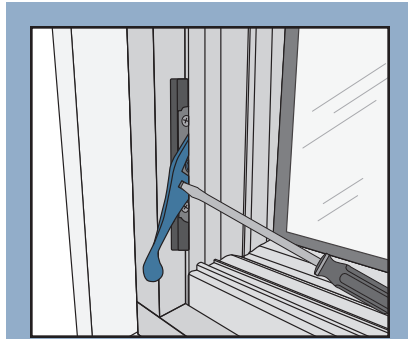

3. Slide the new lever onto the lock until it snaps into place.

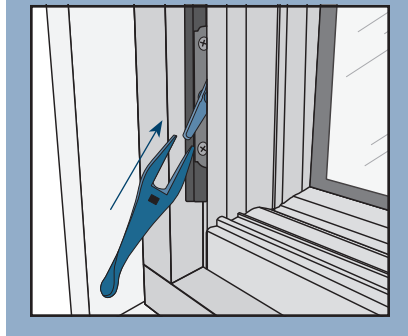

The advice offered herein can be done by a homeowner with some mechanical aptitude. If you are unsure, it is recommended that you hire a trained service provider such as a competent and licensed construction contractor or building professional. JELD-WEN disclaims any and all liability associated with the use and/or provision of these instructions. Any reliance upon the information or advice is at the risk of the party so relying. The information contained herein may be changed from time to time without notification.