

### IMPORTANT INFORMATION

**Note!** Please visit [www.jeld-wen.com](http://www.jeld-wen.com) for additional resources and complete instructions. We have How-To videos and written Product Guides available for most products. Contact us for more information.

### INCLUDED PARTS

- 1 - Adjustable Sill Riser

### PRECAUTIONS AND SAFETY

- Use proper and safe equipment and protective gear as necessary.

### NEEDED TOOLS

- Phillips head screwdriver
- Hacksaw
- Measuring tape
- Putty knife

### INSWING ADJUSTABLE SILL RISER REPLACEMENT

1. Remove foam wedges from both sides of the door.

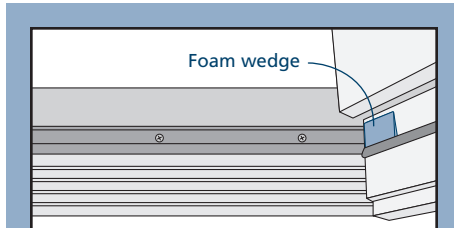

2. Remove all the screws and then remove the sill riser.

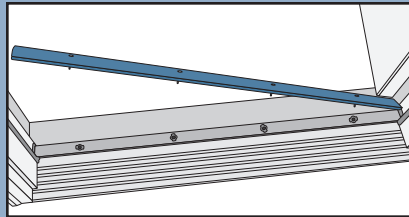
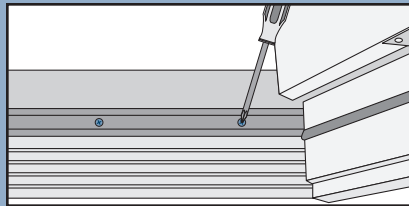

3. Measure removed sill riser from the center of an end screw. Mark and cut new sill riser with a hacksaw.

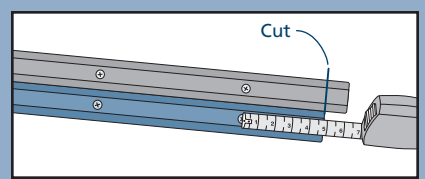

Repeat steps for other end.

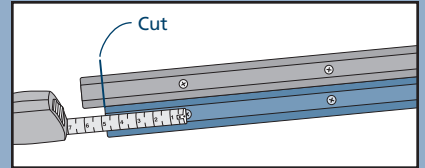

4. Measure inside sill area and use measurement to cut the new sill riser.

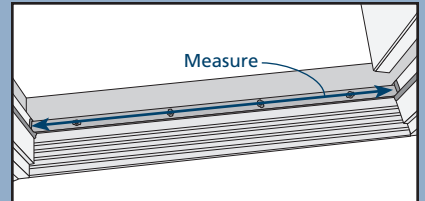

5. Install the new sill riser by driving the screws in the riser into the existing nuts in the sill. Replace foam wedges.

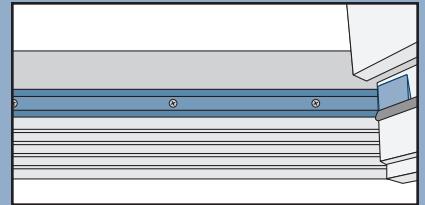

The advice offered herein can be done by a homeowner with some mechanical aptitude. If you are unsure, it is recommended that you hire a trained service provider such as a competent and licensed construction contractor or building professional. JELD-WEN disclaims any and all liability associated with the use and/or provision of these instructions. Any reliance upon the information or advice is at the risk of the party so relying. The information contained herein may be changed from time to time without notification.